

PUNCHING / PERFORATION / TROQUELAR

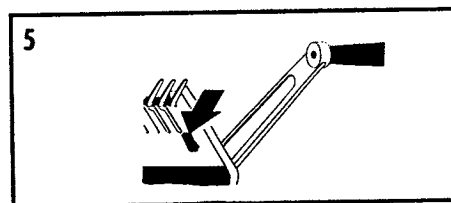

BINDING / RELIURE / ENCUADERNAR

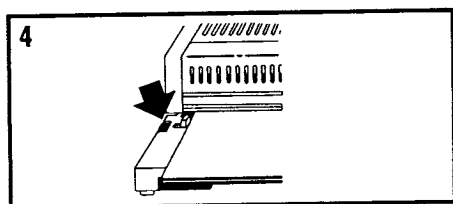
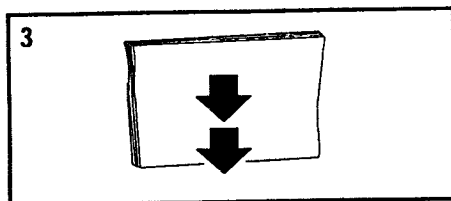
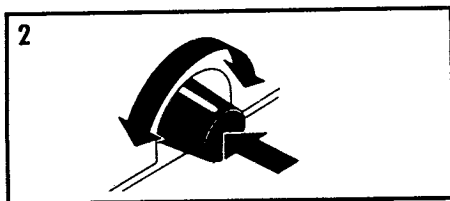
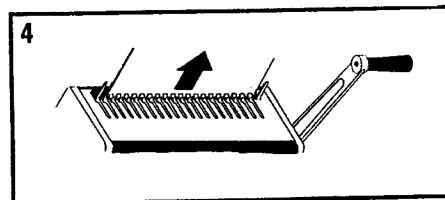
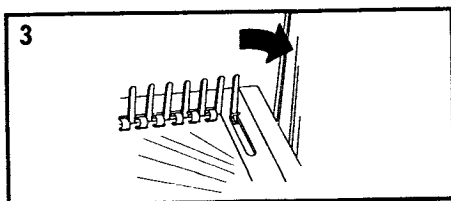
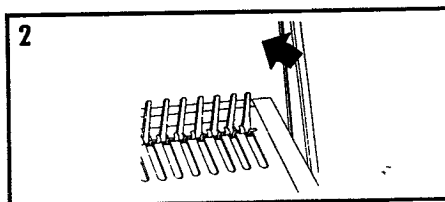
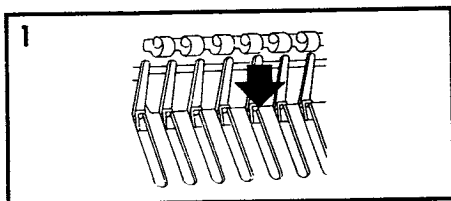

E-KOMBO

INSTRUCTION

MANUAL

Installation and Set-up

Carefully unpack and inspect your new Ibico plastic binding machine for shipping damage. If any damage is noticed it should be brought to the immediate attention of the delivery carrier. Place the machine on a suitable table close to a easily accessible 115 volt outlet.

The following instructions will demonstrate certain methods and techniques to improve your binding results. Before using the machine carefully read through these instructions.

This machine is designed to punch up to 12 sheets of common photo copy paper. Cover materials vary in thickness and composition; as a rule, covers should be punched two at a time separate from the document. Some brands of clear plastic covers and sheet protectors do not punch cleanly and may damage the machine. All Ibico cover materials are manufactured to punch cleanly in any Ibico machine.

Starting the Machine

To start the machine, plug into standard electricity socket (115 V). Punching block moves audibly into starting position. Attach handle right hand side onto shaft end. Secure handle using enclosed screw and allen wrench.

PUNCHING

1. Use guide to determine size of plastic comb.
2. Adjust punching depth with black knob (on right hand side).
3. Fanning and jogging the paper enables all sheets to be placed flush against the paper stop for punching.
4. Place sheets flush into the machine (use side guide for adjustment).
5. Press switch on top right hand side. If too many sheets are used, the punching block automatically reverses back to its original position. Reduce number of sheets to maximum punching capacity and press switch again to restart cycle.

BINDING

1. Place plastic comb open side up behind vertical metal fingers.
2. Push handle toward the rear to open rings of the plastic comb to the desired distance.
3. Set the opening of the comb with black knob (left hand side).
4. Place punched sheets into open comb, front page facing you.
5. Move handle back into original (vertical) position to close binding element.
6. Remove bound and finished book vertically.

Adding and removing pages once bound

To add and delete pages once bound, reverse operation. Your IBICO document is now bound!

Punching Capacity:

10 to 12 sheets (regular copy paper).
Maximum 2 covers (10 MIL).

Note: Empty the waste drawer regularly.

Technical Data:

115 Volts
60 Hz
120 Watts
1.4 amps

IBICO Plastic Comb Guide:

Margin Depth Ø (in) Round No. of sheets (80 gsm)	Position 1	Position 2
	3/16" 1/4" 5/16" 3/8" 7/16"	
	12 20 40 55 70	

Margin Depth Ø (in) Round No. of sheets (80 gsm)	Position 3
	1/2" 9/16" 5/8"
	90 190 120

Margin Depth Ø (in) Round No. of sheets (80 gsm)	Position 4
	3/4" 7/8" 1" 1-1/8"
	150 170 200 220

Margin Depth Ø (in) Oval (S.L.) No. of sheets (80 gsm)	Position 4
	1-1/4" 1-1/2" 1-3/4" 2"
	230 290 360 425

IMPORTANT:

To turn the machine off, disconnect plug from socket.