

BC-10: Recovery Procedures



CAUTION

Turn off the Power Switch before removing jammed paper to avoid the risk of electric shock.

Bird's-eye layout of BC-10

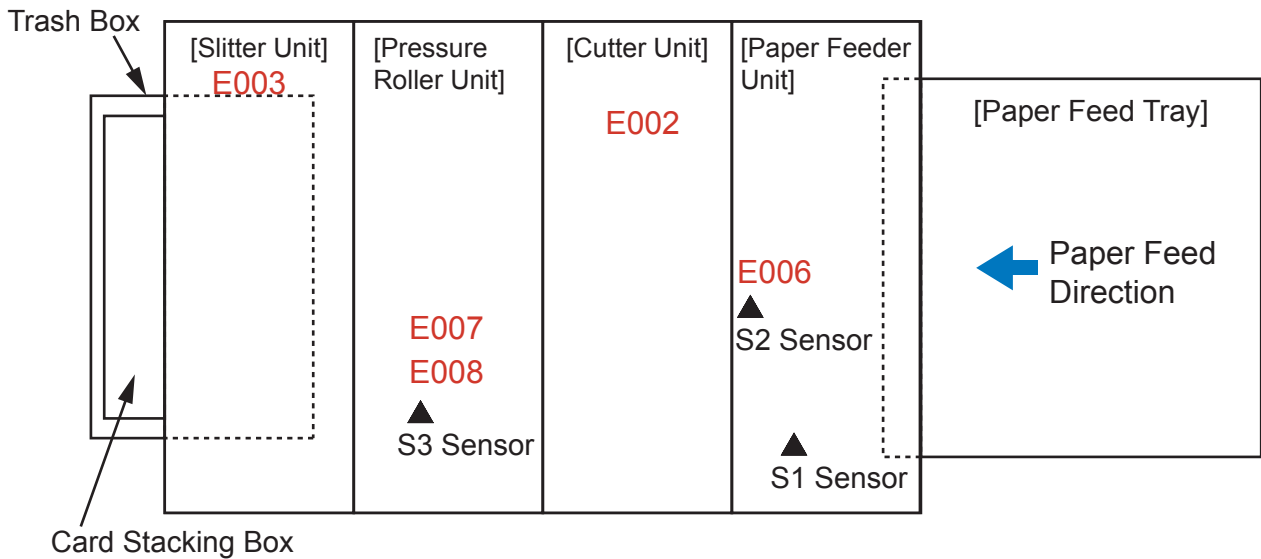

1. Paper feed problems

Symptoms: The BC-10 does not start feeding sheets when you press the Start button but the Feed Roller rotates.

1. Press down the Left Paper Guide on the Paper Feed Tray and pull out the sheets.
2. If the above procedure fails, lift up the Paper Feeder Unit to remove the sheets. See the figure below.

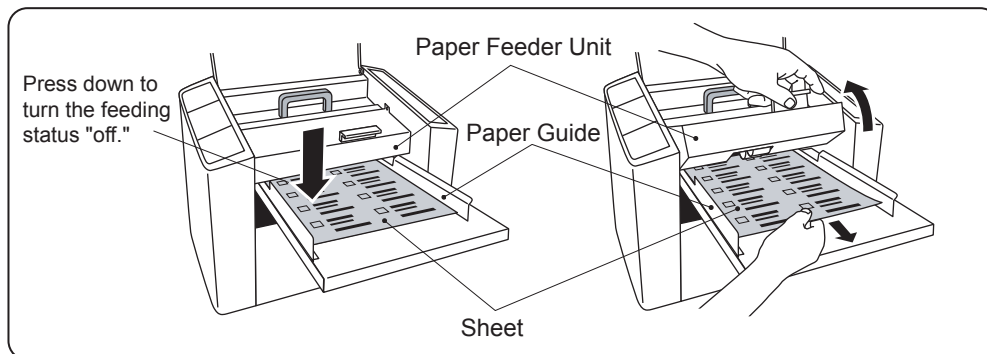

- ◆ Put the Paper Feeder Unit back to its regular position and turn on the Power Switch.

2. "E002" appears in the Display.

The Cutter failed to cut sheets. This error is usually caused by double feeding or a skew.

1. Turn the power on, and press the Ready/Clear button.
2. Turn the power off. Lift up the Paper Feeder Unit and remove the jammed sheet.
 - ◆ Put the Paper Feeder Unit back to its regular position and turn on the Power Switch.

3. "E003" appears in the Display.

This indicates the Slitter Unit is not set properly or detached.

- ◆ Set the Slitter Unit properly.

4. "E006" appears in the Display.

This indicates the lead edge of a sheet did not reach the S2 sensor in time or a paper fragment is stuck under the S2 sensor.

- ◆ Lift up the Paper Feeder Unit and push the jammed fragment(s) into the Trash Box. Press the Ready/Clear button.
- ◆ If the Ready/Clear button does not work, turn the power off. Wait 7 seconds and turn the power on again.
- ◆ The Pressure Roller Unit must be set properly or sheets will not be conveyed completely. That can keep fragments from falling into the Trash Box.

5. "E007" appears in the Display.

This indicates a sheet did not reach the S3 sensor in time.

1. Detach the Pressure Roller Unit to remove the jammed sheet (See the figure below).
2. Return the Pressure Roller Unit back to its regular position. (Press down the Unit completely until the ball catches on both sides of the Unit go click.)

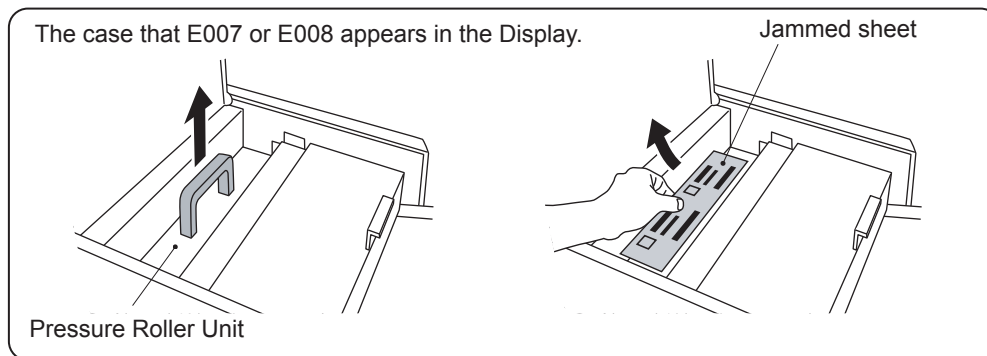

- ◆ Turn the power on and press the Ready/Clear button to recover.

6. "E008" appears in the Display.

This indicates a sheet did not transit through the S3 sensor in time.

- ◆ Do the same procedures described in the E007 case to clear this error.
- ◆ Though E007 or E008 appears, there are some cases that a sheet has been successfully conveyed to the Slitter Unit. In these cases, you may not find any jammed sheet.