



care about  
money



speed



counterfeit  
detection



operation  
ease



design



support



quality

Manufactured by Cassida Corporation, USA  
[cassidausa.com](http://cassidausa.com)

**Cassida**  
2200

Caring about your money

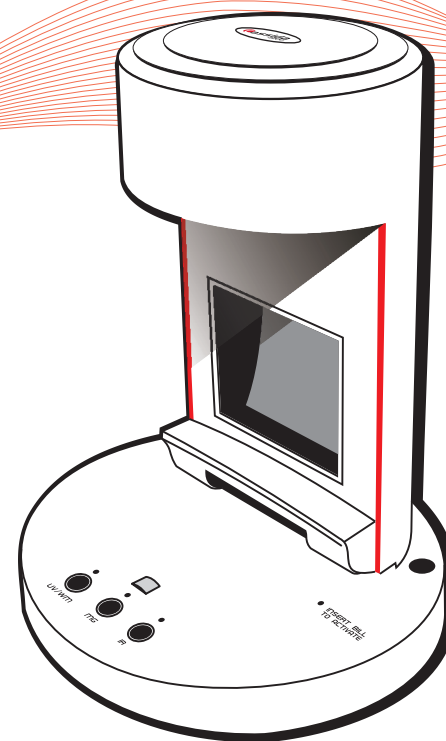

**USER MANUAL**

CASSIDA 2200 ADVANCED COUNTERFEIT DETECTOR

This manual contains important information on safety measures and operational features, please read it carefully before operating your detector and keep it for future reference.

**Table of contents:****1. Getting started**

1.1 About Cassida 2200	5
1.2 Box contents	5
1.3 The detector view	6
1.4 Specifications	7
1.5 Important safety instructions	7

**2. Detection modes**

2.1 Infrared detection mode	8
2.2 Ultraviolet detection mode	9
2.3 Watermark detection mode	9
2.4 Magnetic detection mode	9

**3. Other authentication methods**

3.1 Magnification of the design features	10
3.2 Chemical paper analysis	10

**4. Maintenance and Warranty**

4.1 Maintenance	11
4.2 Warranty	11

**1. GETTING STARTED****1.1 ABOUT CASSIDA 2200**

The Cassida 2200 can help you authenticate any security feature present on a US dollar bill. Along with traditional methods such as magnification, watermark and paper authentication, the detector is capable of identifying UV fluorescent and magnetic marks. The Cassida 2200's most distinctive feature is a new and powerful IR technology which enables you to view the bill's infrared image. The Cassida 2200 uses the most advanced and so far uncounterfeited infrared (IR) technology to authenticate the bill. The infrared camera transmits the bill's infrared image to the large built-in monitor enabling you to instantly verify its authenticity.

**1.2 BOX CONTENTS**

- Cassida 2200 detector
- Power adapter
- Chemical analysis pen
- Optical magnifier
- User manual

## 1.3 VIEW OF THE CASSIDA 2200

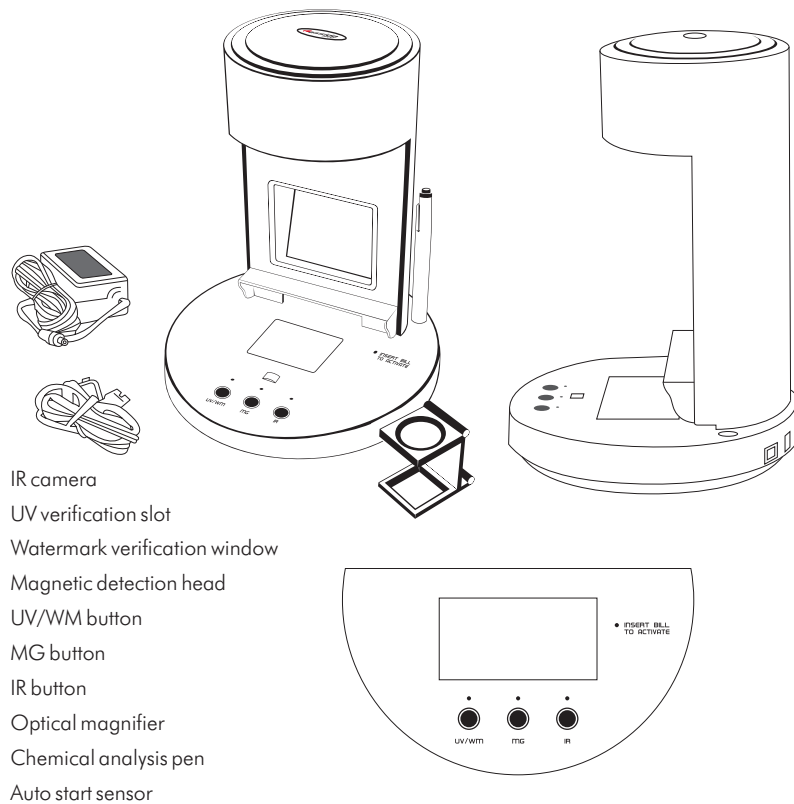

## 1.4 SPECIFICATIONS

Power supply:	110 VAC 60 Hz or 220 VAC 50 Hz
Power consumption:	<30w
Ambient temperature:	-10°C~45°C
Ambient humidity:	40-90%
Net weight:	1.6 kg (3.5 lbs)
Dimensions:	217x195x285 mm (8.5"X7.7"X11.2)
Counterfeit detection:	IR infrared detection UV Ultraviolet detection MG magnetic detection Watermark verification Microprinting authentication Chemical paper analysis

## 1.5 IMPORTANT SAFETY INSTRUCTIONS

When using this unit, basic safety precautions should always be taken, including the following:

- Only use the AC/DC adapter provided with the unit. The use of other AC/DC adapters may result in electrical shock, fire or cause serious damage to the unit.
- Do not use this product in areas where it may be exposed to water or other liquids.
- Unplug this product from the wall outlet before cleaning. Do not use liquid or aerosol cleaners. Use a damp cloth for cleaning.
- To reduce the risk of electrical shock, do not disassemble this product.

- Take it to a qualified service personnel when service or repair work is required.
- Opening or removing covers may expose you to dangerous voltages or other risks. Incorrect reassembly can cause electrical shock when the appliance is subsequently used.
- Do not operate the unit in areas with high temperature or high humidity since it may prevent it from working correctly.
- Do not use the unit if the power cord is damaged or if the plug socket contact is loose. Failure to do so may result in electrical shock or fire.
- When not using the unit for a long period of time, remove the power plug from the wall outlet.

## 2. DETECTION MODES

### 2.1 INFRARED DETECTION MODE

To switch to infrared mode press the “IR” button Place the bill on the watermark window (make sure it covers the sensor), to activate the monitor. Allow a few seconds for the monitor to turn on.

Verify that hidden IR marks are present on the image.

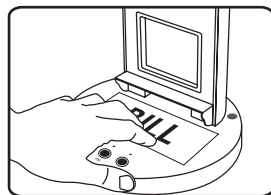
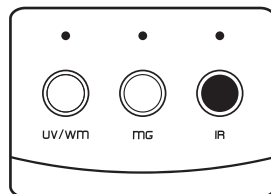

### 2.2 ULTRAVIOLET DETECTION MODE

To switch to this mode press the “UV/WM” button until the ultraviolet (UV) light turns on Place the bill in the UV verification slot. Verify if UV fluorescent marks are present. If not used for 15 seconds the UV light shifts to a sleep mode. Placing the bill in the verification slot (make sure it covers the sensor) will automatically reactivate the UV light.

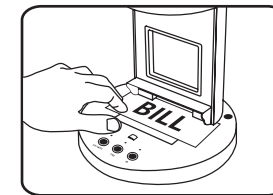
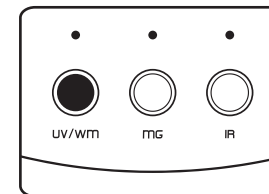

### 2.3 WATERMARK DETECTION MODE

When turned on, unit automatically defaults to this mode.

To switch to watermark mode from another mode press the “UV/WM” button until the white light turns on. Place the bill on the watermark window Verify if the watermark is present on the bill. If not used for 15 seconds the light will shift to a sleep mode. Placing the bill on the watermark window (make sure it covers the sensor) will automatically reactivate the light.

### 2.4 MAGNETIC DETECTION MODE

To switch to this mode press the “MG” button. Magnetic detection head will be activated. Rub the area of the bill that contains the magnetic ink against the detection head. If the magnetic marks are present the detector will beep and the watermark window will flash

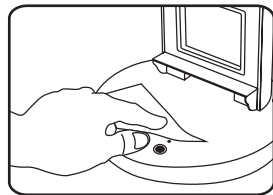
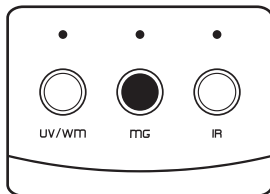

### 3. OTHER AUTHENTICATION METHODS

#### 3.1 MAGNIFICATION OF THE DESIGN FEATURES

Unfold the supplied magnifying glass and use it to verify the anti counterfeit design features of the bill.

#### 3.2 CHEMICAL PAPER ANALYSIS

Use the supplied pen to put a mark on any area of the bill. If the mark turns dark brown or black the bill may be counterfeit. The mark will turn a gold or a yellow color on the genuine bill.

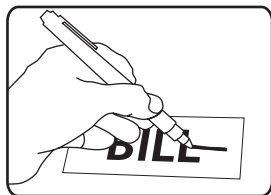

### 4. MAINTENANCE AND WARRANTY

#### 4.1 MAINTENANCE

Clean the monitor and the IR camera protection glass with a soft cloth. In case of malfunction contact Cassida Technical Service at [www.cassidausa.com](http://www.cassidausa.com)

#### 4.2 WARRANTY

All cassida products are warranted for a period of one year from the date of purchase. Warranty does not cover shipment cost to and from Cassida Technical Service Center.

Visit our website [www.cassidausa.com](http://www.cassidausa.com) for the service center contact information.

If you need to contact Cassida Technical Service Center please have the following information with you:

- Product model: Located on the bottom of your detector
- Serial number: Located on the bottom of your detector
- Nature of problem: What happens and when does it happen? Did machine display an error message?
- Steps already taken to resolve the problem and the results